

IMPORTANT

These drawings are provided as a general guide and may be amended without prior notice. Please contact Euroglass for specific design.

NOTES:

1. This balustrade system complies with New Zealand Building Code Clauses B1 Structure, B1/AS1 Amendment 15, F2 Hazardous Building Materials and F4 Safety From Falling Third Edition, subject to:

- all products meeting the required performance specification
- site installation carried out in accordance with intent of this drawing
- minimum balustrade height of 1000mm from finished floor level

2. Based on commercial occupancies B,E and C3 of Table 3.3 AS/NZS 1170.1 and very high wind zone or less (1.76 kPa), maximum height and anchor spacings are:

- Maximum height 1200mm
- spaced at 400 mm crs

3. The design of the concrete, steel or timber support for the balustrade is the responsibility of others.

4. A handrail of 32-50mm diameter is required for stairs and ramps exceeding 1:20 slope. Refer NZBC D1/AS1.

5. Viridian glass options according to 22.4.3 of NZS 4223.3:2016 are:

- 15mm toughened glass with interlinking rail
- 17.52m toughened SentryGlas laminated glass with a minimum pane width of 1200mm

6. Interlinking rail must be connected to each glass pane or the building.

7. Maximum distance from side edge of glass to fixings is 200mm.

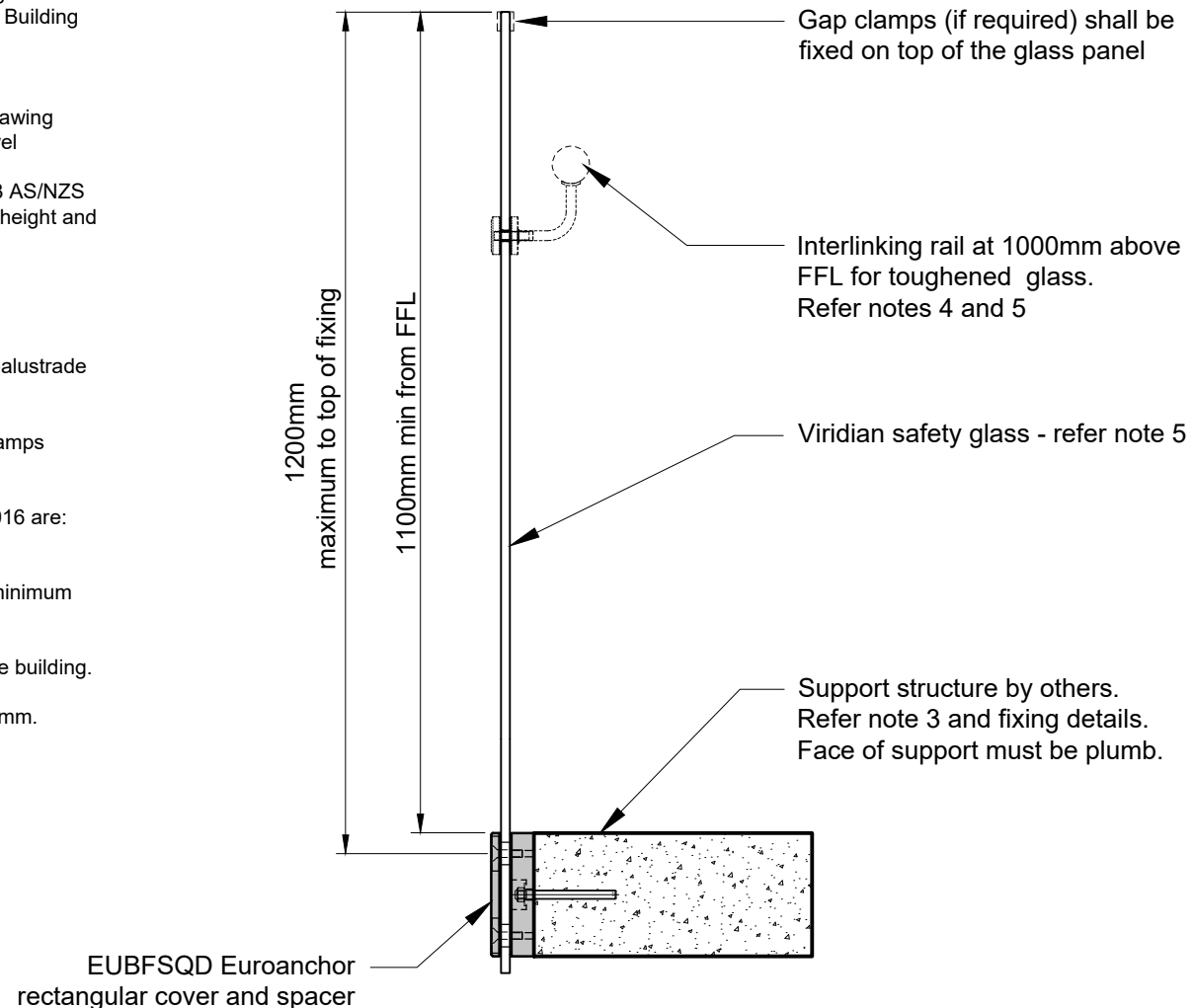

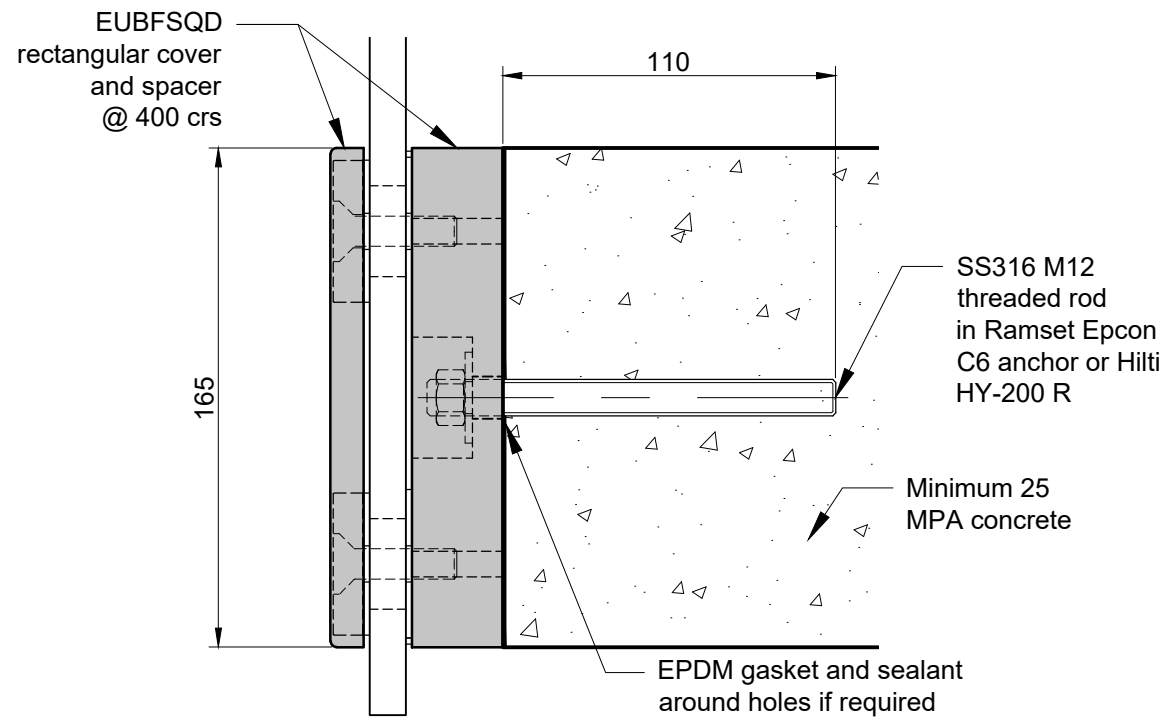

FIXING DETAIL for CONCRETE